



OPERATION

To increase back pressure turn Y23-72-B screw clockwise with Y106-105 allen wrench which is furnished with unit. To decrease back pressure turn Y23-72-B screw counter-clockwise.

SERVICE HINTS

1. If outlet pressure rises or creeps, check **D** seat assembly and **E** pushrod for foreign material. If **D** seat assembly and **E** pushrod appear to be worn or eroded, they should be replaced.
2. If material is leaking through bleed hole in 29919 housing and nut assembly, replace 29000 and 29269 diaphragms.

DISASSEMBLY

WARNING: DO NOT DISASSEMBLE UNIT WHEN UNDER PRESSURE. Relieve all pressure on regulator before starting the following procedure.

To disassemble unit, unscrew the (4) Y154-54-C and (2) Y154-56-C screws from the (6) Y22-10-C nuts. Lift the 29919 housing and nut assembly from the 29494 base. Remove the 29273 spring cap and **B** spring. Disassemble **C** back-up plate by unscrewing **E** pushrod. The 29000 and 29269 diaphragms are now accessible. Unscrew **D** seat assembly from the 29494 base. This provides access to **D** seat assembly and 29449 seal.

ASSEMBLY

To assemble unit, use new 29449 seal, place it on 29494 base. Screw **D** seat assembly into 29494 base and tighten to 20 ft. lbs. To assemble diaphragm place the 29000 and 29269 diaphragms together. Place the 29269 diaphragm next to the hex over the threaded end of the **E** pushrod. Screw **E** pushrod into **C** back-up plate and tighten, making sure all holes in the diaphragms align. Insert **E** pushrod into center hole of **D** seat assembly. Align holes in diaphragms with holes in base. Place **B** spring and 29273 spring cap on top. Place 29919 housing and nut assembly on the 29000 diaphragm. Insert (4) Y154-54-C and (2) Y154-56-C screws through the holes in the 29919 housing and nut assembly. Place (6) Y22-10-C nuts on screws and tighten.

27528-XXX

STAINLESS STEEL STANDARD CAPACITY MATERIAL REGULATOR

(BACK PRESSURE TYPE)
1/4" INLET/OUTLET

27528-000
5-125 PSI

27528-100
0-50 PSI

27528-200
10-250 PSI

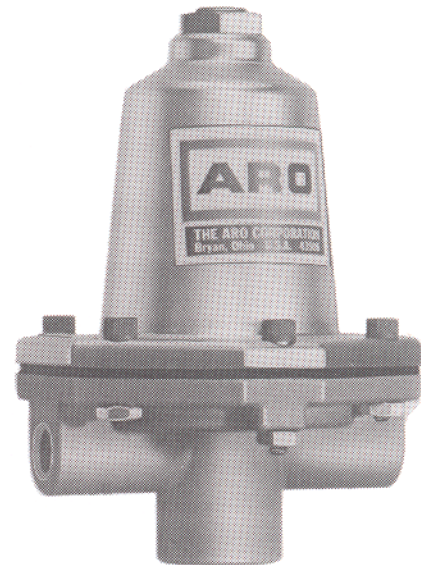

DO NOT EXCEED MAXIMUM INLET PRESSURE OF 125 PSI (9 BAR)

**NOTICE: READ THIS MANUAL CAREFULLY BEFORE OPERATING,
INSTALLING OR SERVICING THIS EQUIPMENT.**



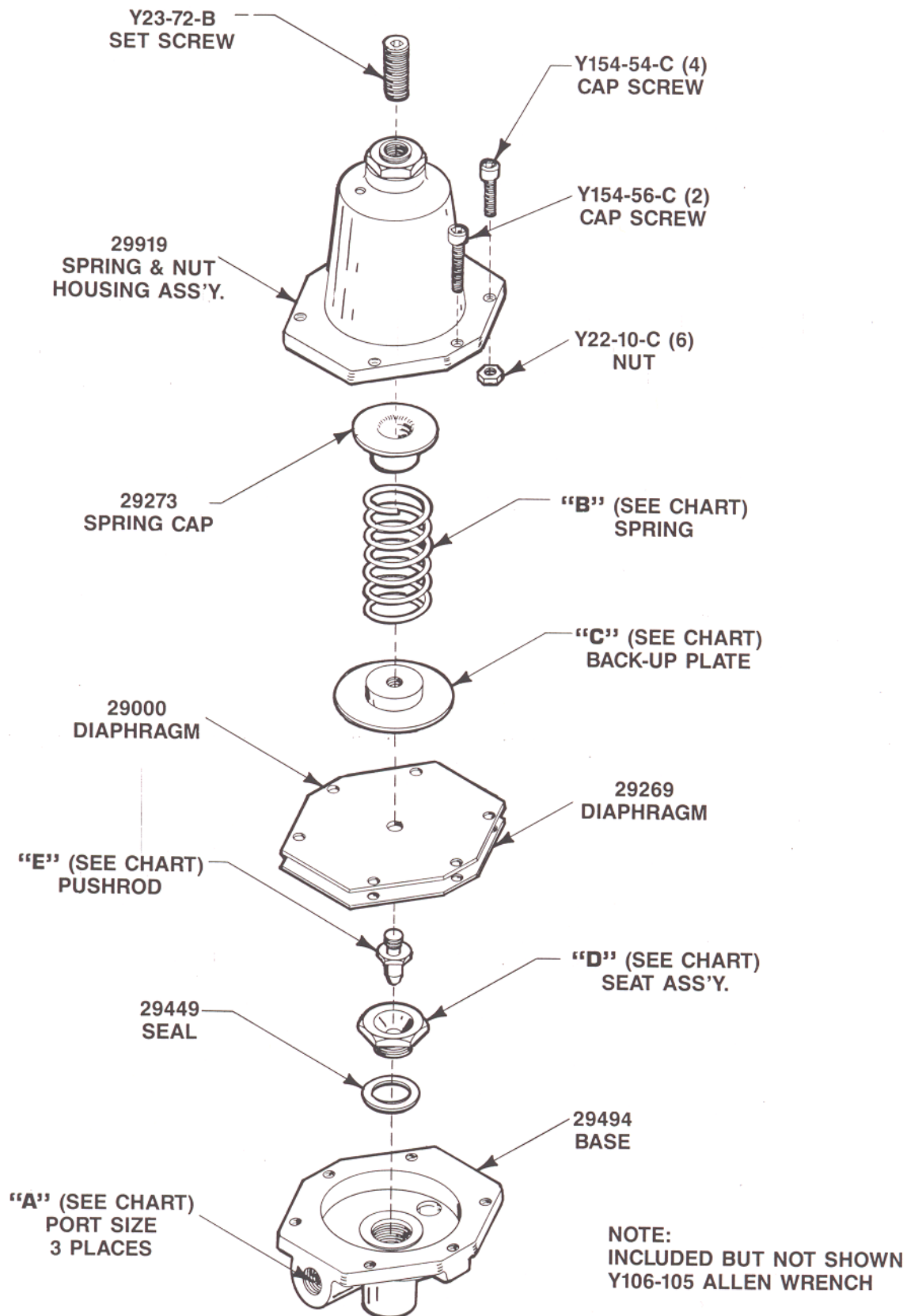

| MODEL NO. | "A" PORT SIZE | "B" SPRING | "C" BACK-UP PLATE | "D" SEAT ASS'Y. | "E" PUSHROD |
|-----------|------------------|----------------|----------------------|--------------------|----------------|
| 27528-000 | 1/4 NPTF | 29002 (5-125) | 29001 | 104001 | 29493 |
| 27528-100 | 1/4 NPTF | 29119 (0-50) | 29001 | 104001 | 29493 |
| 27528-200 | 1/4 NPTF | 29120 (10-250) | 29155 | 104001 | 29493 |